

# PS7k C-SF12-9

## Solar surface pump system

### Applications

- Drinking water supply
- Pond management
- Irrigation
- Livestock watering
- Pressurizing systems

### Characteristics

- Fast, failure-free installation
- Excellent serviceability
- High reliability and life expectancy
- Short Return of Investment (ROI) cycle
- Lower Total Cost of Ownership (TCO)

### Technical data

Total dynamic head	max. 90 m
Flow rate	max. 17 m <sup>3</sup> /h
Vmp*	> 575 V
Voc	max. 800 V

### Standards

**CE** 2006/42/EC, 2004/108/EC, 2006/95/EC

IEC/EN 61702:1995,  
IEC/EN 62253 Ed.1

The logos shown reflect the approvals that have been granted for this product family. Products are ordered and supplied with the approvals specific to the market requirements.



### Components

#### Controller: PS7k

- Controlling and monitoring
- Control inputs for dry running protection, remote control etc.
- Protected against reverse polarity, overload and overtemperature
- Integrated MPPT (Maximum Power Point Tracker)

#### Motor:

- Highly efficient 3-phase AC motor
- Frequency 50 Hz
- Enclosure Class IP55

#### Pump end: PE C-SF12-9

- High reliability and life expectancy
- Premium materials
- Optional: dry running protection



## PS7k C-SF12-9

### Solar surface pump system

#### Pump chart

Vmp\* > 575 V

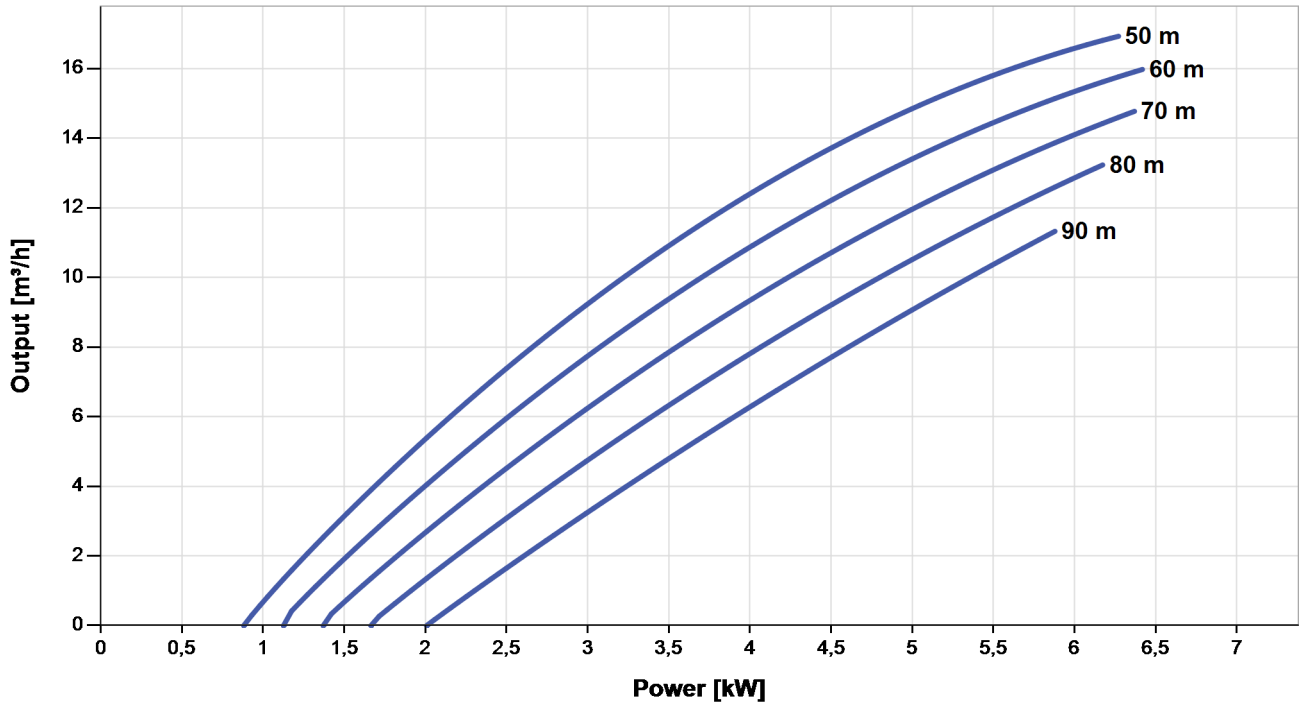

#### Dimensions and weights

##### Controller

H = 350 mm  
 H1 = 310 mm  
 H2 = 295 mm  
 W = 250 mm  
 W1 = 235 mm  
 D = 200 mm  
 D1 = 200 mm  
 D2 = 167 mm

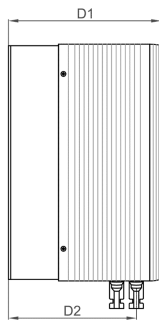
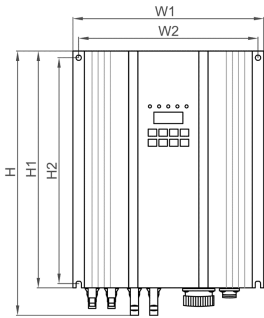

##### Pump unit [mm]

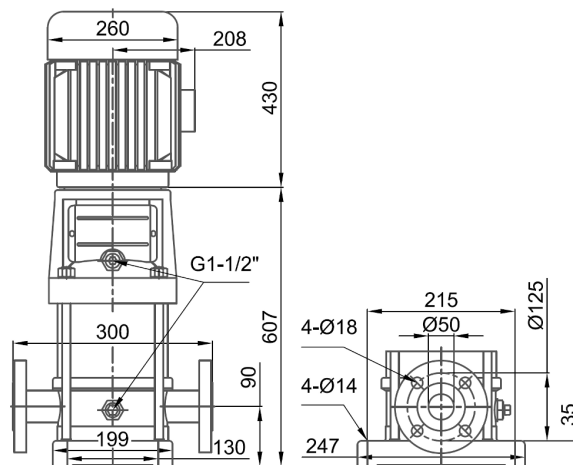

	Net weight
Controller	9,0 kg
Pump unit	76 kg
Motor	59 kg
Pump end	17 kg

\*Vmp: MPP-voltage under Standard Test Conditions (STC): 1000 W/m² solar irradiance, 25 °C cell temperature

